

CONTRACTOR TO VERIFY:

(A) _____ OVERALL LADDER HEIGHT
 (B) _____ F.F. TO TOP OF DECKING
 (C) _____ ROOF HATCH BASE HEIGHT
 (D) _____ WALL TO ϕ OF LADDER
 (E) _____ LADDER WIDTH

APPROVED BY: _____
 DATE: _____

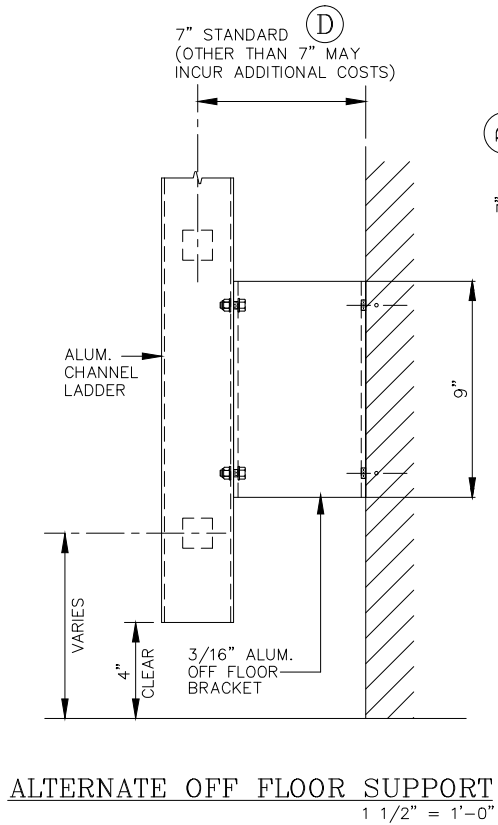
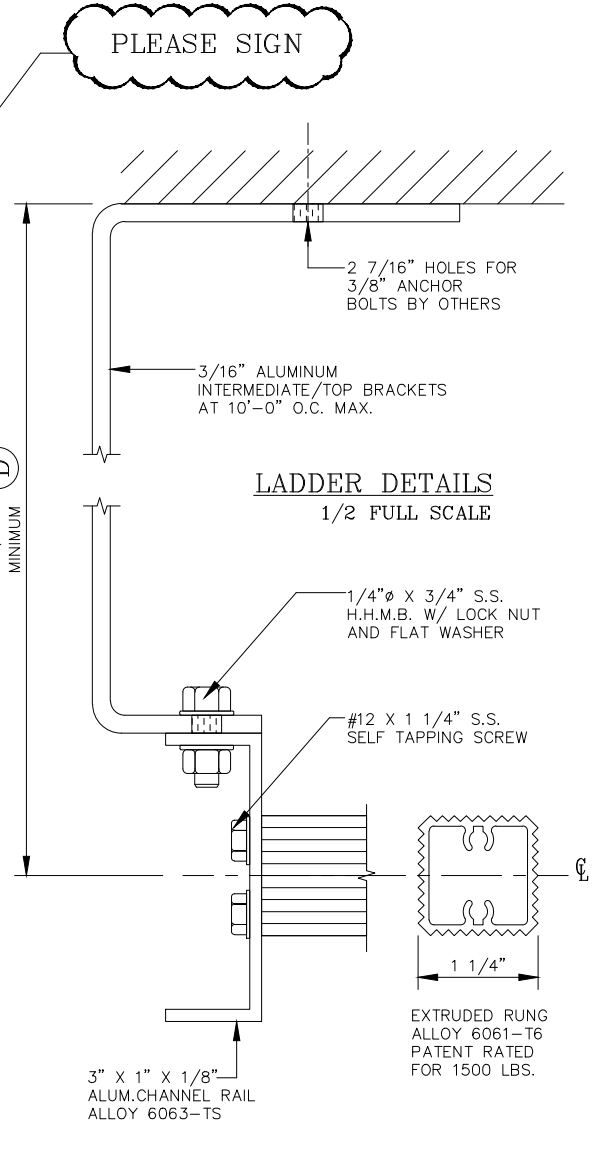

O'KEEFFE'S, INC.
 100 N. HILL DR. SUITE 12 TEL: (415) 824-4900
 BRISBANE, CA 94005-1010 FAX: (415) 824-5900

**STANDARD DUTY CHANNEL RAIL
 FIXED ACCESS ALUMINUM LADDER MODEL 500**

_____ QUANTITY

SECURITY DOOR ALTERNATE BOTTOM SUPPORT
 INTERMEDIATE BRACKET MILL FINISH BRONZE ANODIZED
 _____ POWDER COATING CLEAR ANODIZED

SALE NO.

DRAWN : _____
 DATE : _____
 SHEET : _____ OF _____