

**CONTRACTOR TO VERIFY:**

(A) \_\_\_\_\_ OVERALL LADDER HEIGHT  
 (B) \_\_\_\_\_ F.F. TO TOP OF DECKING  
 (C) \_\_\_\_\_ ROOF HATCH BASE HEIGHT  
 (D) \_\_\_\_\_ WALL TO ? OF LADDER  
 (E) \_\_\_\_\_ LADDER WIDTH

APPROVED BY: \_\_\_\_\_  
 DATE \_\_\_\_\_

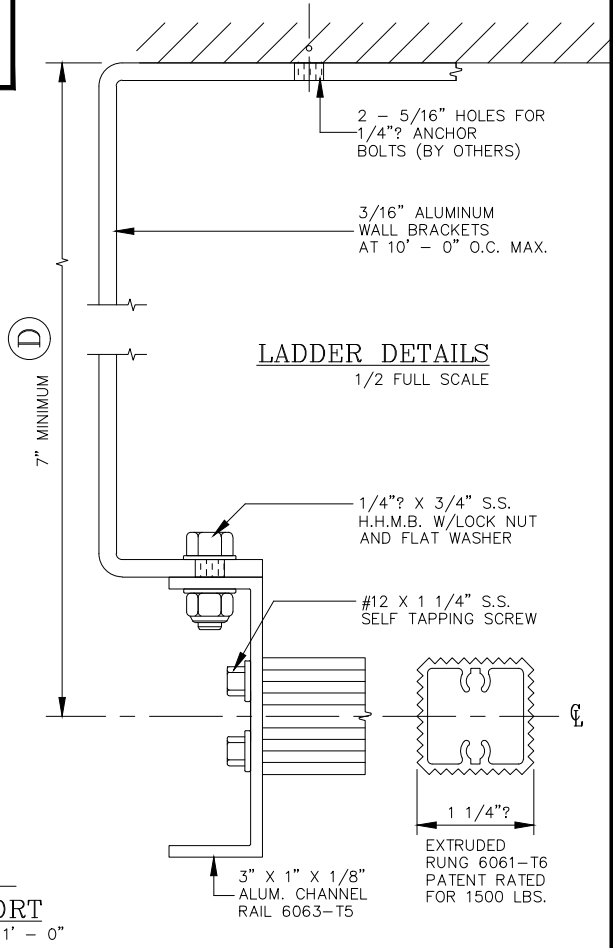
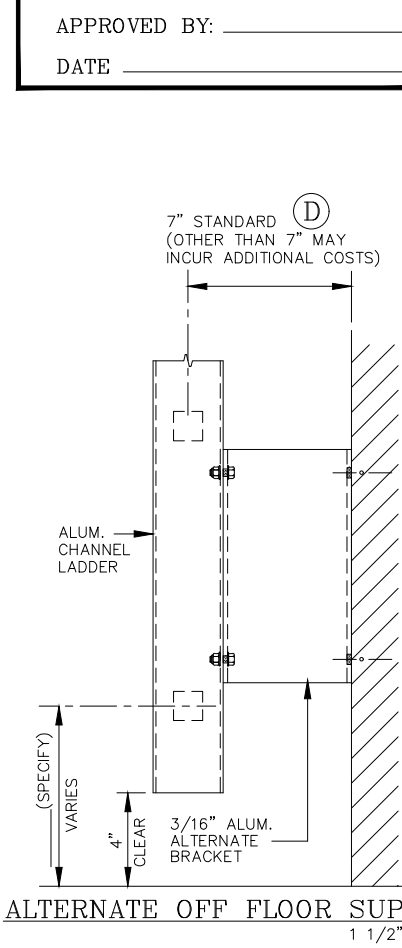

**O'KEEFFE'S, INC.**  
 100 N HILL DR, STE 12 TEL: (888) 653-3333  
 BRISBANE, CA 94005 FAX: (888) 653-4444 www.okeeffes.com

**STANDARD DUTY CHANNEL RAIL  
 FIXED ACCESS ALUMINUM LADDER MODEL 500**

_____ QUANTITY	<input type="checkbox"/> ALTERNATE BOTTOM SUPPORT
<input type="checkbox"/> SAFETY POST	<input type="checkbox"/> MILL FINISH <input type="checkbox"/> BRONZE ANODIZED
<input type="checkbox"/> INTERMEDIATE BRACKET	<input type="checkbox"/> POWDER COATING <input type="checkbox"/> CLEAR ANODIZED

**SALE NO.**

DRAWN : \_\_\_\_\_

DATE : \_\_\_\_\_

SHEET : \_\_\_\_\_ OF \_\_\_\_\_