

CONTRACTOR TO VERIFY:

(A) _____ OVERALL LADDER HEIGHT
 (B) _____ F.F. TO TOP OF DECKING
 (C) _____ ROOF HATCH BASE HEIGHT
 (D) _____ WALL TO ϕ OF LADDER
 (E) _____ LADDER WIDTH

APPROVED BY: _____
 DATE _____

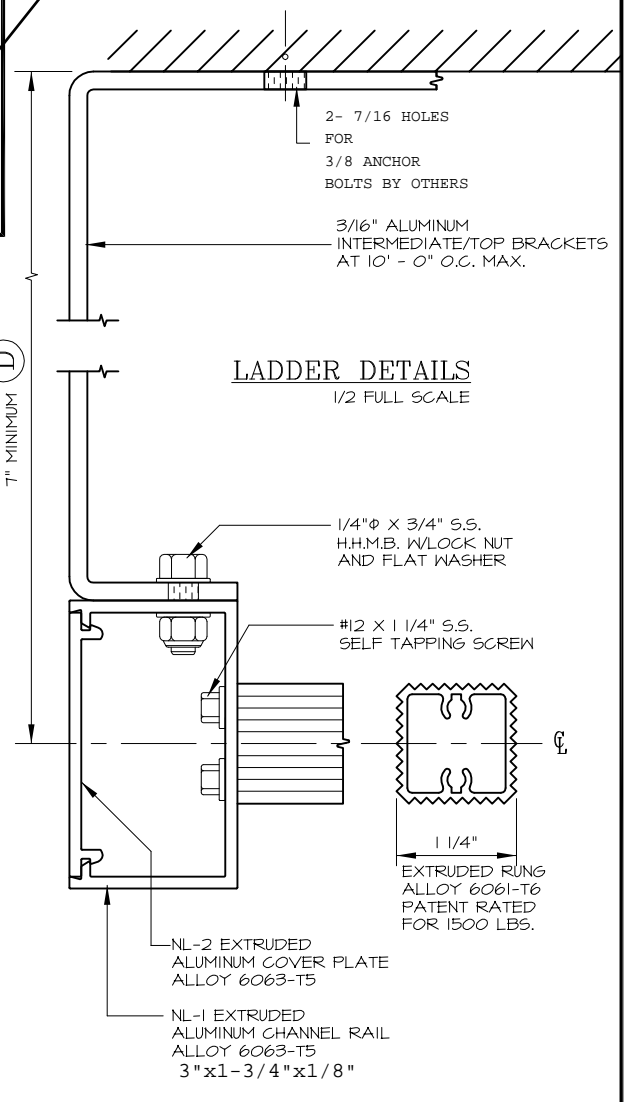
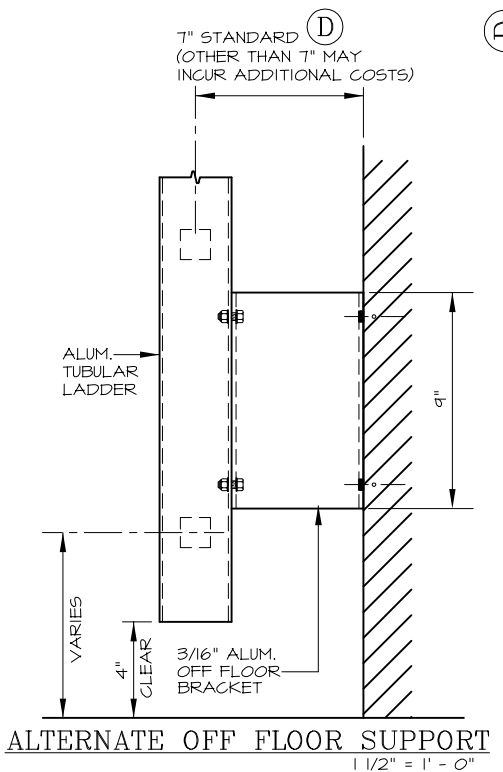

O'KEEFE'S, INC.

100 N HILL DR, STE 12
BRISBANE, CA 94005
TEL: (888) 653-3333
FAX: (888) 653-4444 www.okeeffes.com

**HEAVY DUTY TUBULAR RAIL
FIXED ACCESS ALUMINUM LADDER MODEL 501**

- | | |
|---|---|
| _____ QUANTITY | <input type="checkbox"/> ALTERNATE BOTTOM SUPPORT |
| <input type="checkbox"/> SAFETY POST | <input type="checkbox"/> MILL FINISH |
| <input type="checkbox"/> INTERMEDIATE BRACKET | <input type="checkbox"/> POWDER COATING |
| | <input type="checkbox"/> BRONZE ANODIZED |
| | <input type="checkbox"/> CLEAR ANODIZED |

SALE NO.

DRAWN : _____

DATE : _____

SHEET : _____ OF _____